

# Works progress update for the Chipping Warden area

12<sup>th</sup> February 2020



# Current programme of works

**Fusion are currently undertaking the following highways scope of works in your area.**

- Modifications to the Welsh Road crossroads with the A361
- Chipping Warden relief road construction and connections onto the A361
- Modifications to the highway in Wardington
- Preparatory works at the Banbury M40 Junction 11 junction ahead of new and additional traffic lights installation
- Modifications to Greatworth (Sulgrave Road)



# Current concerns

- Traffic Management
- Congestion
- Programme and reliability of works
- Bus service route 200



# Impact management

Manually controlling traffic signal at peak periods (7:00 to 9:30am and 3pm to 6pm)

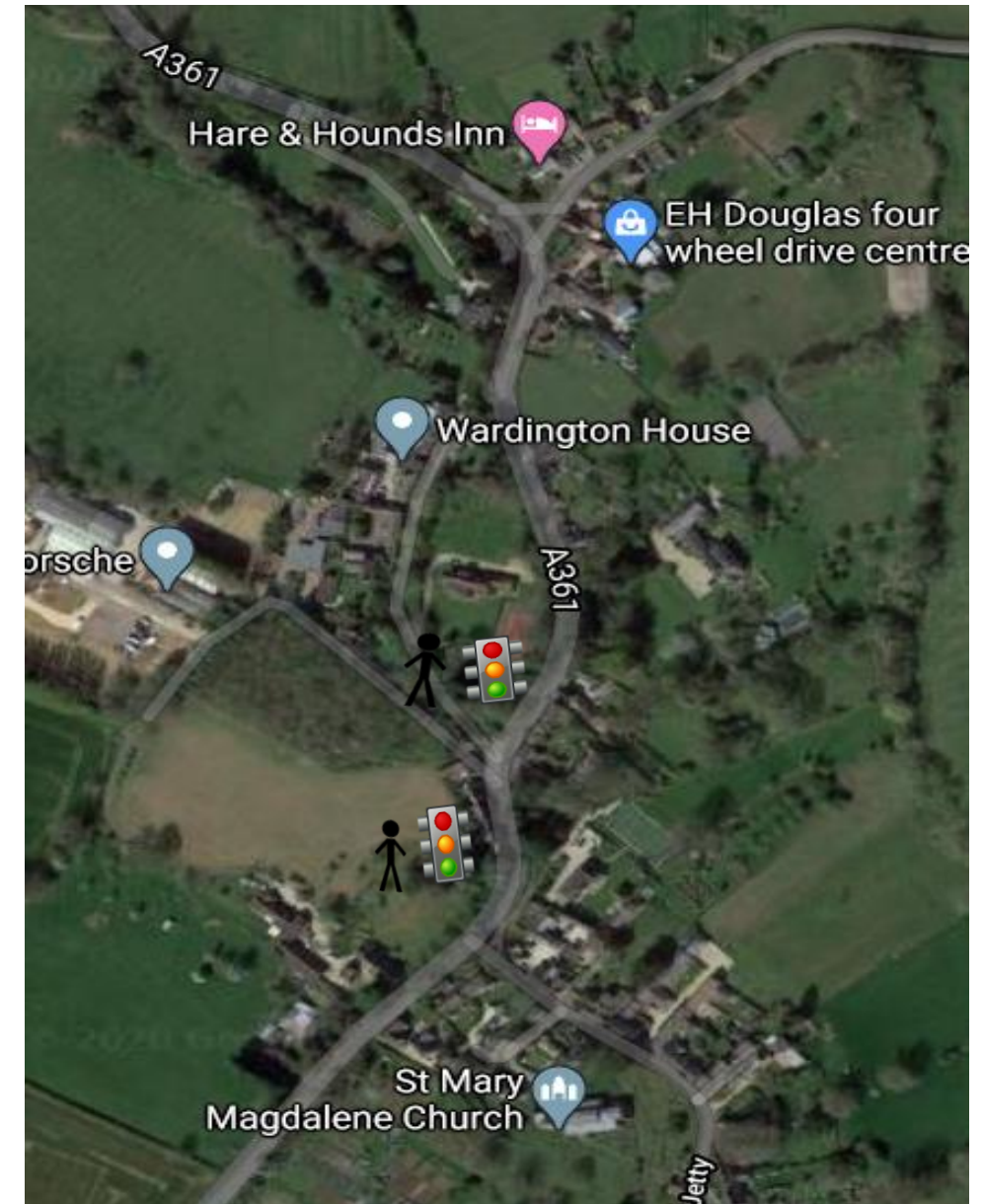

# Impact management

Disruption to bus service on A361 Route 200 (stagecoach)

Location	Number of impacted days on Stagecoach	Number of impacted days on Stagecoach after mitigation	Comment
<b>Wardington</b>	18	0	Change works from day to night
<b>Chipping warden (North tie-in)</b>	6	0	Utilise a short duration approved bus diversion of 4.8km with 5 mins driving time
<b>Chipping Warden (south tie-in)</b>	8	4 Under further review through a possible local diversion for the bus service	Closures for Chipping Warden (South) and Welsh Road are weekends from Friday 20:00 to Monday 06:00. Each closure requires a different calendar date to maintain public access either side of the respective closure.
<b>A361 through Welsh road</b>	6	3	
<b>Total Closures</b>	38days	7 days	

# Works Introduction-Welsh Road

- The works at this location is to re-align the cross junction to a staggered junction to improve visibility and safety.
- The works are being carried out under lane closure and at times a full road closure.
- Three sequential phases of road closure will be required to complete the works.
  1. Welsh Road East
  2. Welsh Road West
  3. A361



# Traffic management plan- WR (Full closure)

Start	End	Location	Time
Nov 2019	Mar 2020	Welsh Road East	24/7
Mar 2020	May 2020	Welsh Road West	24/7
29/05/2020	01/06/2020	Closure of A361 through Welsh road	Friday 8pm – Monday 6am
05/06/2020	08/06/2020	Closure of A361 through Welsh road	Friday 8pm – Monday 6am
12/06/2020	15/06/2020	Closure of A361 through Welsh road	Friday 8pm – Monday 6am



Only one road closure will be deployed at any one time



# Works Introduction - Chipping Warden

- The Chipping Warden Relief Road will remove through traffic from the village. The relief road joins the A361 to the north and west of the village.
- The road will be constructed in two stages. Stage one works in ongoing by Fusion and Stage two will be completed by MWCC (EK) upon completion of the cut and cover tunnel.
- During Stage 1, full road closures of the A361 will be required to connect the relief road into the existing A361.
- To minimise disruption to road users, schools and businesses, the full road closures will take place at weekends ( Fridays 8pm to Mondays 6am)





# Chipping Warden relief road

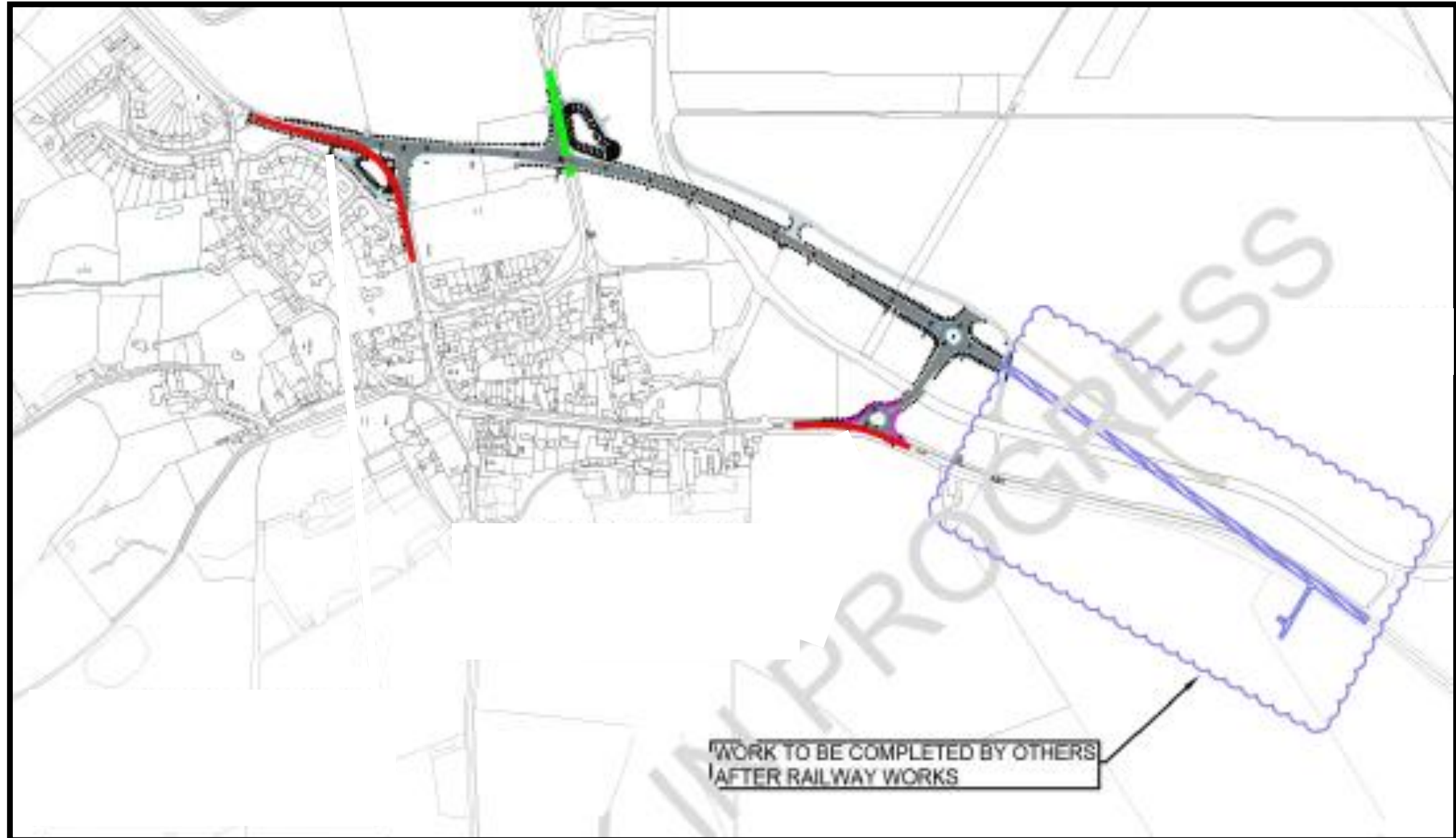

Chipping warden phase 1 works layout

# Traffic management plan- CW (Lane closure)

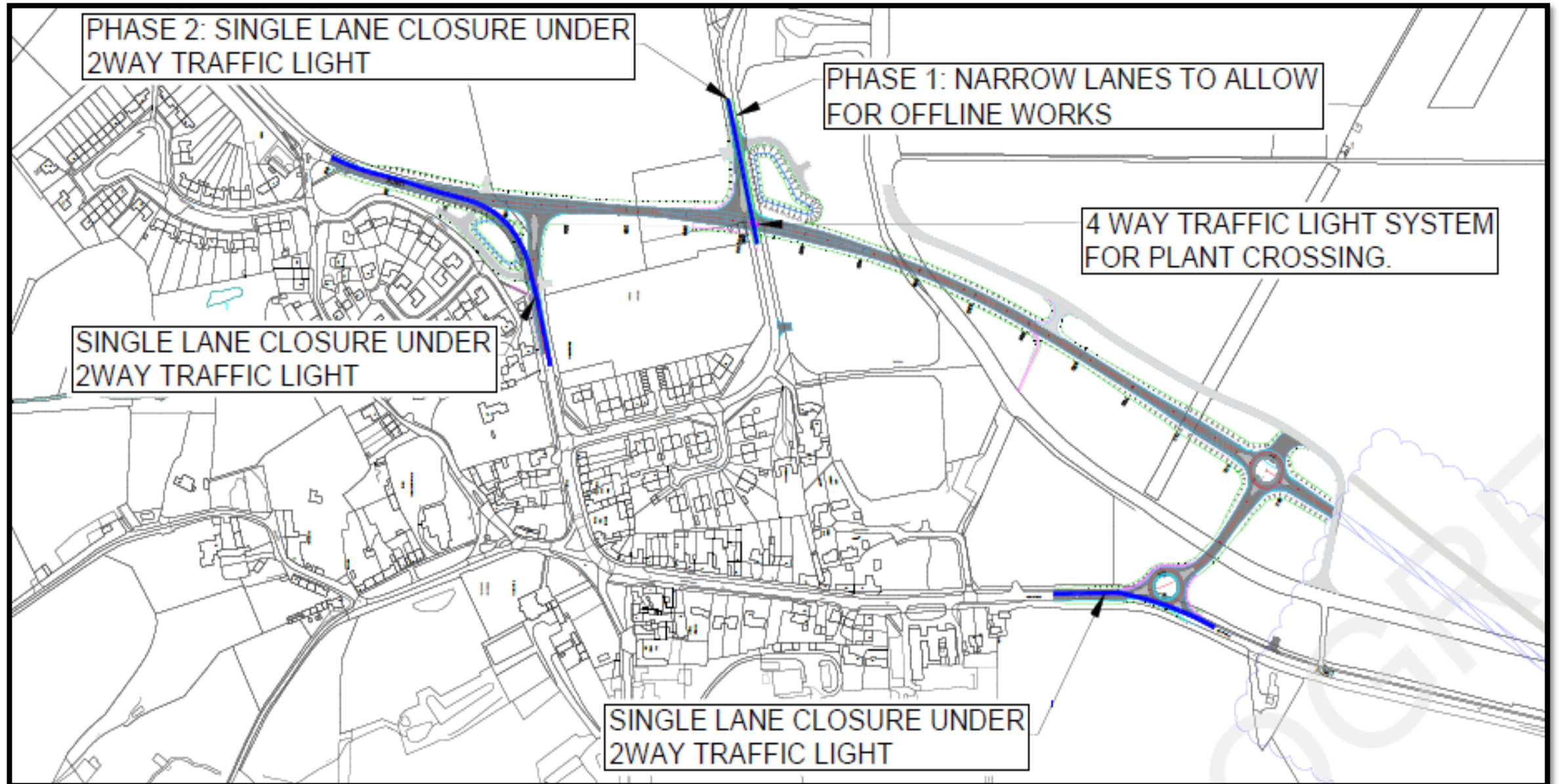

To safely carry out the works in the blue highlighted area, one lane of the A361 will be closed under 2way traffic light system

# Traffic management plan- CW (Full closure)

Start	End	Location	Time
21/02/2020	24/02/2020	Closure on A361 (South tie-in)	Friday 8pm – Monday 6am
24/04/2020	27/04/2020	Closure on A361 (South tie-in)	Friday 8pm – Monday 6am
15/05/2020	18/05/2020	Closure on A361 (South tie-in)	Friday 8pm – Monday 6am
22/05/2020	25/05/2020	Closure on A361 (South tie-in)	Friday 8pm – Monday 6am

Start	End	Location	Time
28/02/2020	02/03/2020	Closure on A361 (North)	Friday 8pm – Monday 6am
06/03/2020	09/03/2020	Closure on A361 (North)	Friday 8pm – Monday 6am
03/04/2020	06/04/2020	Closure on A361 (North)	Friday 8pm – Monday 6am
29/05/2020	01/06/2020	Closure on A361 (North)	Friday 8pm – Monday 6am

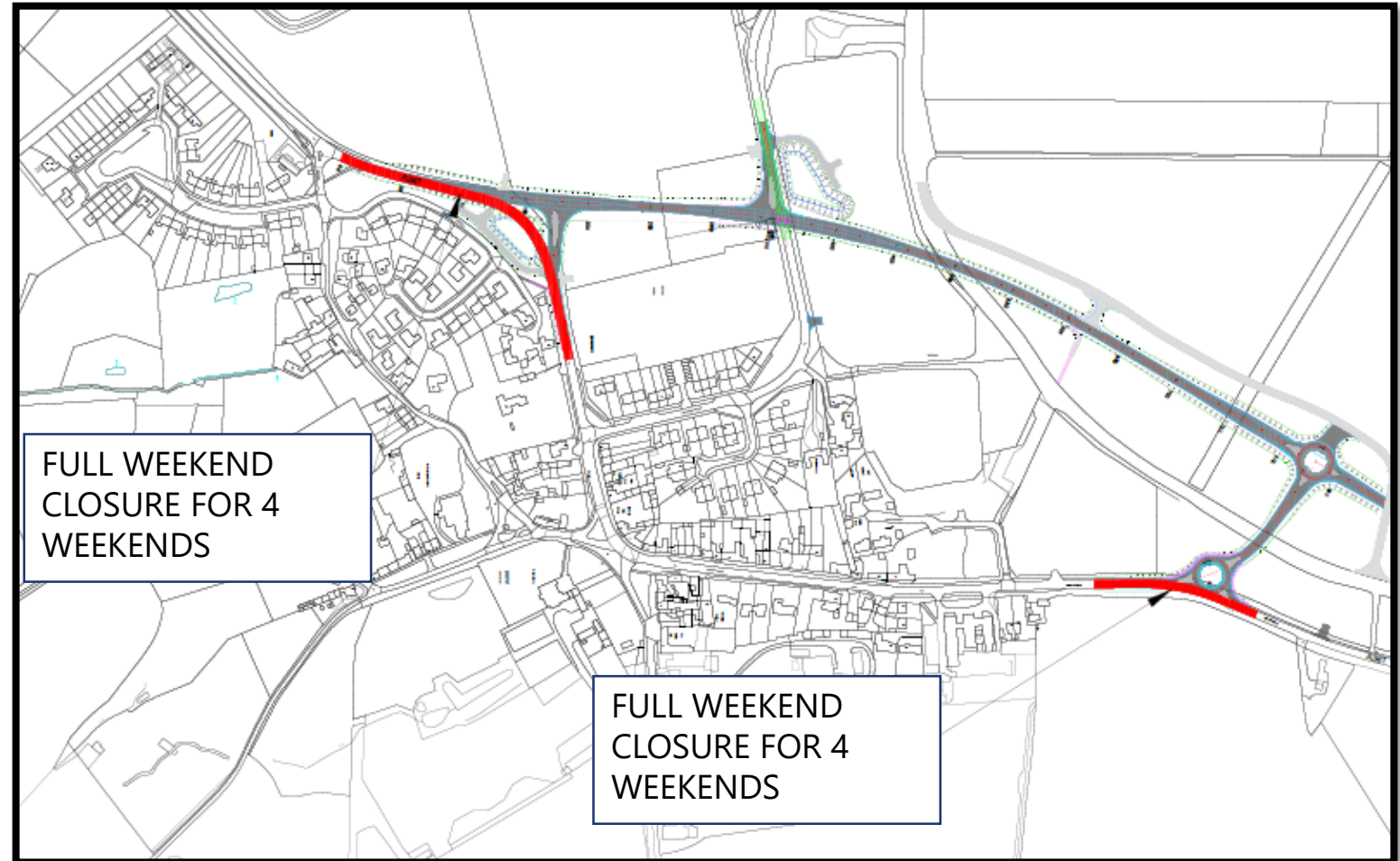

Only one road closure (highlighted in red) will be deployed at any one time



# Works Introduction-Wardington

- The scope of works include widening the A361 road at three bends within the village, provision of a pedestrian crossing, installation of new village gateways, chevron signs and vehicle activated signs.
- The works will be carried out under lane closure and at times full road closure
- 
- To minimise disruption to road users, businesses and public transport, the full road closure will be between 8pm and 6am (weekdays only)



# Wardington through A361 Full road Closures

Location	Dates	Time
Widening 3	15 to 21 April 2020	8pm to 6am
Puffin Crossing	15 to 21 May 2020	8pm to 6am
North Gateway	02 to 04 June 2020	8pm to 6am
South Gateway	02 to 04 June 2020	8pm to 6am

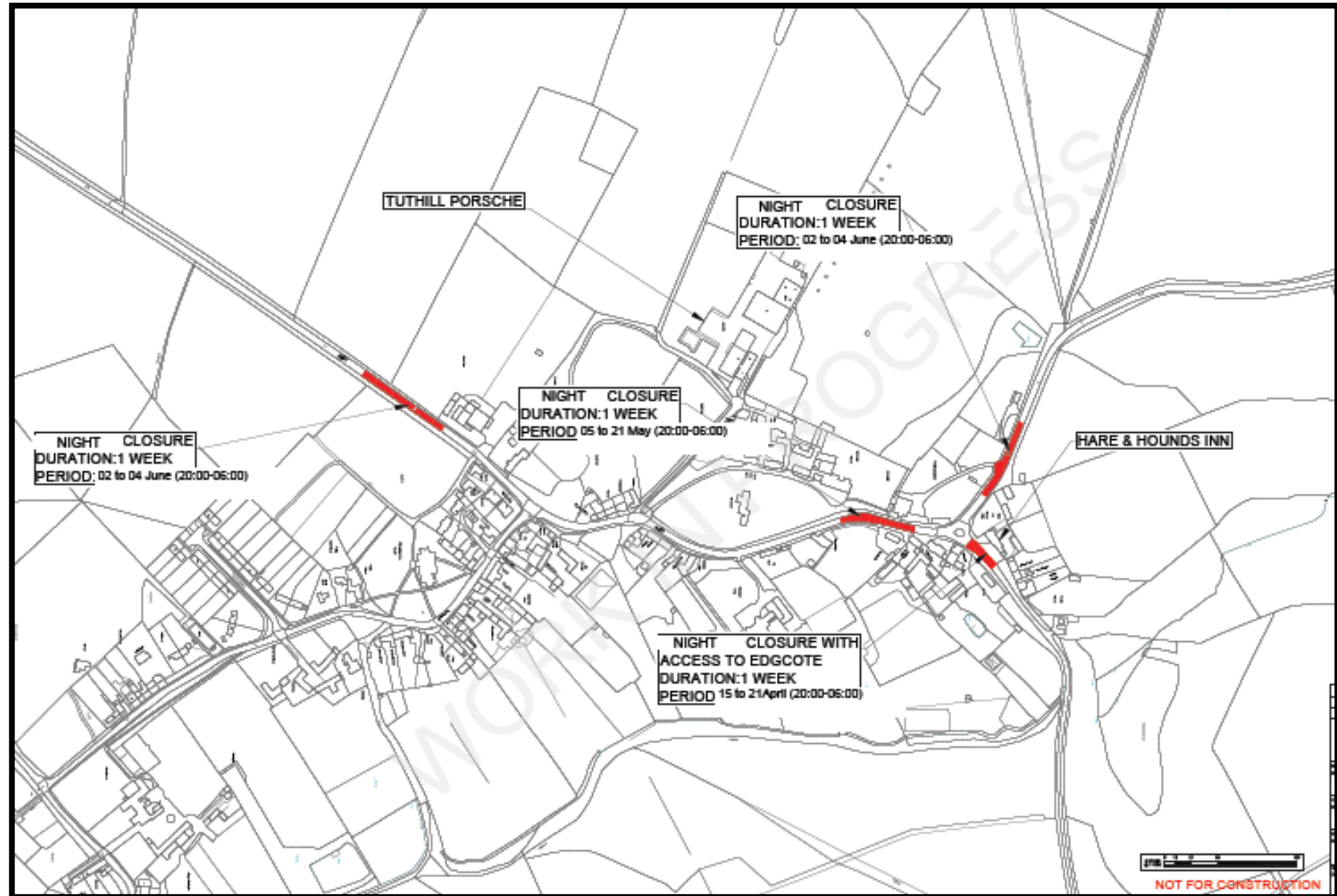

- Only one road closure (highlighted in red) will be deployed at any one time

# Works Introduction – Greatworth (Sulgrave Junction) improvement

- The junction improvement works will add in a right turn lane onto the B4525 Welsh Road, and improve the visibility splays to make movements at the junction safer. The junction is in close proximity to the proposed HS2 Greatworth Green Tunnel.
- The works will be carried out under lane closure and at times full road closure.
- To enable us complete the works, the full road closure are planned to be:-
  - 24/7 on Sulgrave Road between November 2019 and May 2020
  - 24/7 for 2 weeks on B4525 between April 2020 and May 2020



# Traffic management plan- Greatworth (Sulgrave)

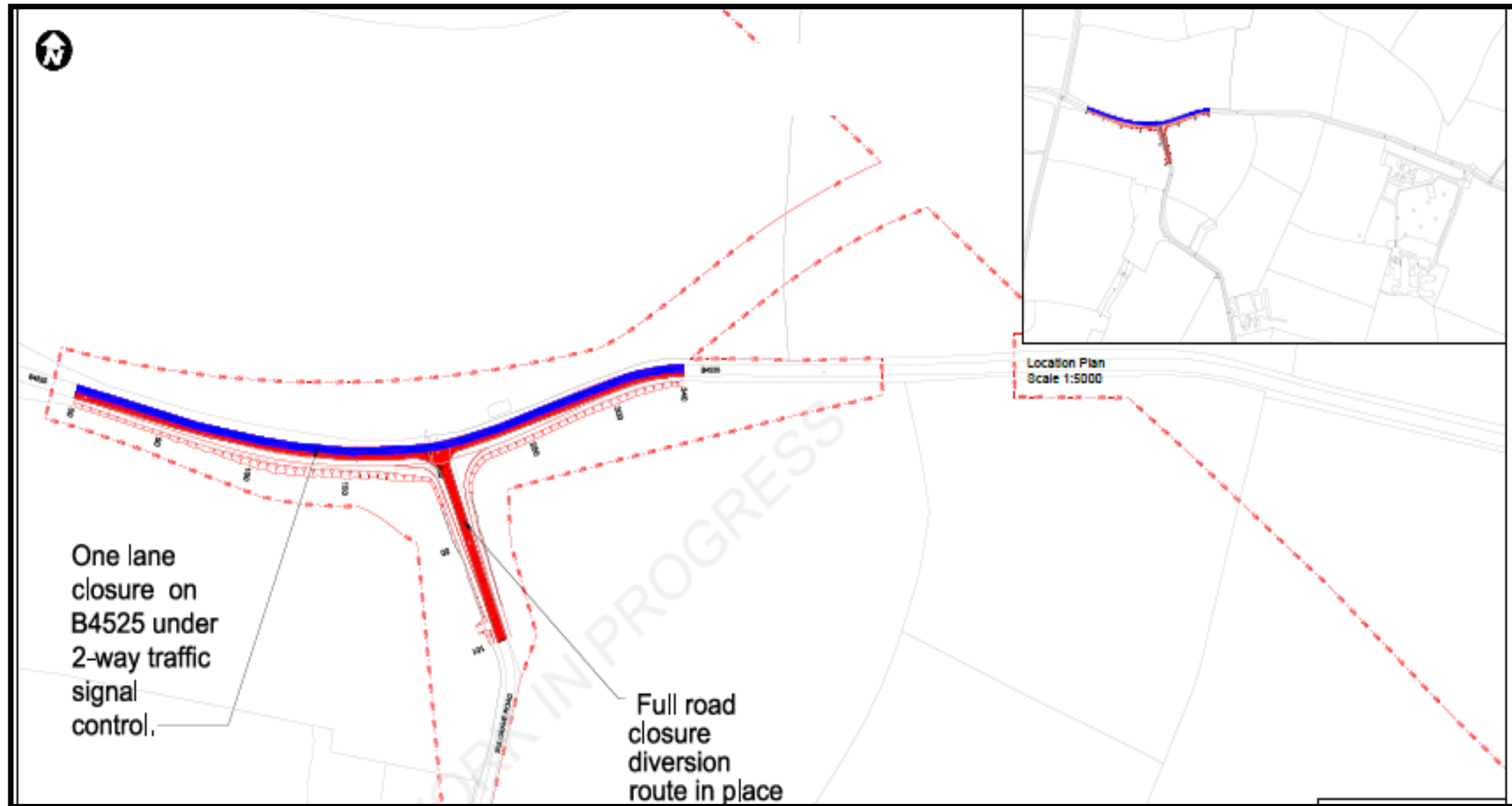

- Sulgrave Road + one lane on the B4525 will remain fully closed until May 2020
- Full road closure on B4525 and Sulgrave Road planned for two weeks at the end of April and early May 2020

# Works Introduction- M40 J11

- The scope of works includes the introduction of intelligent control into the existing signals and also signalisation of the A422 (W) Hennef Way, retaining the free flow slip onto the M40.
- The works will be carried out under lane closure.
- Full road closure traffic management might be required to install the traffic light loops.
- Localise lane closures will be in place between February 2020 and June 2020.
- To minimise disruption, works will be carried out at night between Mondays and Fridays
- 2<sup>nd</sup> March M40 J11 local business presentation.





# M40 Junction 11 Area of works

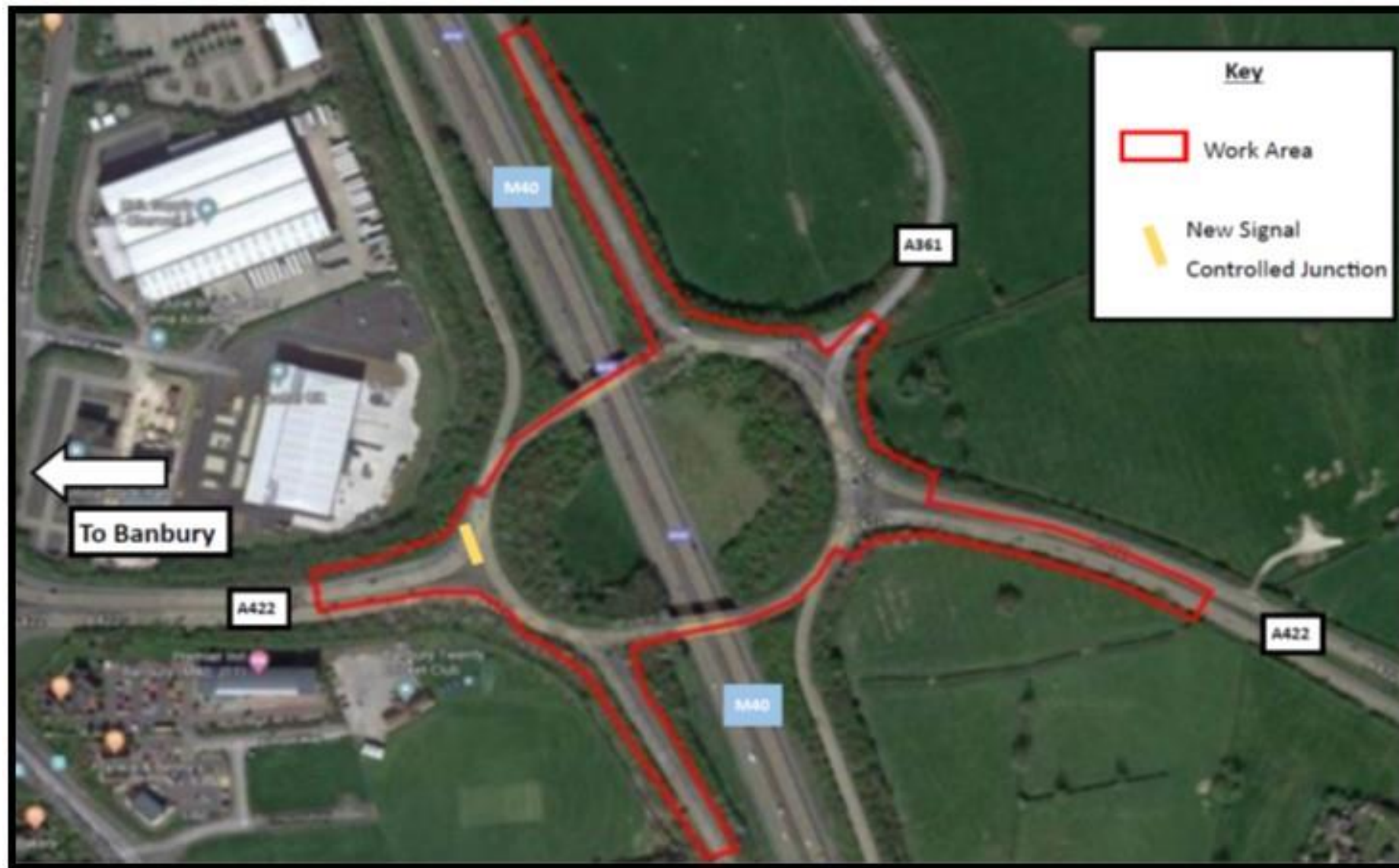

- A localised night time lane closure will be in place from February to June 2020
- M40 J11 will remain open at all times – Only Lane Closures.
- Works have been planned to be carried out weekday nights

**THANK YOU**

